

# SERIES R304

2x2 and 2x4  
Retrofit Kit  
For Recessed Troffers

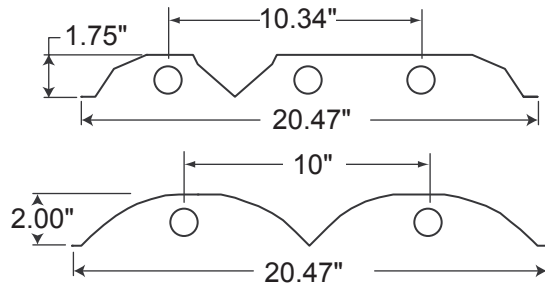
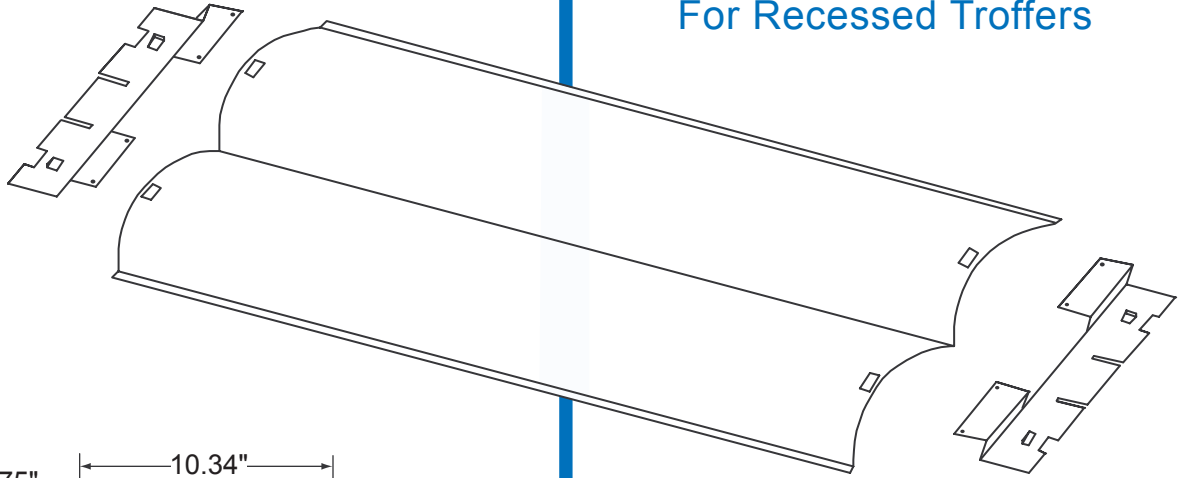

UNION MADE IN THE USA.

## ORDERING:

NOMINAL SIZE	LAMPS	CATALOG NUMBER
2' X 2'	2-FO17	R304-224T8
2' X 4'	2-FO32	R304-248T8
2' X 2'	3-FO17	R304-324T8
2' X 4'	3-FO32	R304-348T8

## FEATURES:

- COMPUTERIZED DESIGN IMPROVES LIGHT DISTRIBUTION
- TOOL FREE REFLECTOR INSTALLATION
- LABOR SAVING DESIGN PROVIDES INSTANT BALLAST ACCESS
- POST PAINTED HIGH REFLECTANCE POWDER COAT FINISH
- STANDARD STYLES INCLUDE 2X2 AND 2X4 SIZES IN 2 OR 3 LAMP VERSIONS

## NOTES:

1. BALLAST NOT INCLUDED
2. SEE R303 FOR PRE-WIRED BALLAST INCLUDED

## INSTALLATION INSTRUCTIONS

TURN OFF POWER TO THE FIXTURES.

REMOVE LAMPS AND BALLAST COVER.

DISCONNECT BALLAST FROM POWER SUPPLY.

REMOVE AND DISCARD EXISTING SOCKET PLATE AND BALLAST IN ACCORDANCE WITH LOCAL CODES AND REQUIREMENTS.

INSERT NEW LAMP HOLDERS INTO PROVIDED SOCKET PLATE.

INSTALL AND CONNECT NEW BALLAST (**BY OTHERS**) TO LAMPHOLDERS PER DIAGRAM ON BALLAST LABEL.

SECURE SOCKET PLATES WITH "TEK" SCREWS SO THAT THE LAMPHOLDERS ARE AGAINST THE ENDS OF THE FIXTURE AND CENTERED LONGITUDINALLY

CONNECT BALLAST LEADS TO POWER SUPPLY ( ENSURE BALLAST IS GROUNDED TO FIXTURE).

**NOTE: IF THE INCOMING POWER IS END FED, BEND CENTER TAB DOWN TO ALLOW ROOM FOR WIRES TO PASS.**

SNAP R304 REFLECTOR INTO TABS LOCATED ON SOCKET PLATES.

CLEAN REFLECTOR, INSTALL LAMPS AND TURN ON POWER.

### NOTE

All fixtures must be installed,  
wired and grounded in accordance  
with the National Electric Code and all  
other applicable codes.

### !!! WARNING !!!

RISK OF FIRE OR ELECTRICAL SHOCK. ELECTRICAL PARTS MAY BE DAMAGED WHEN DRILLING OR USING "TEK" SCREWS FOR INSTALLATION OF MOUNTING HARDWARE. CHECK ENCLOSED WIRING AND COMPONENTS. USE CAUTION WHEN DRILLING "TEK" SCREWS INTO A BLIND AREA. TO PREVENT WIRING DAMAGE DO NOT EXPOSE WIRING TO SHARP EDGES.

