

SERIES 379

1X4

Lay - In Parabolic

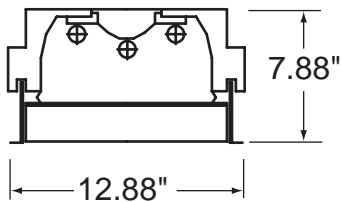
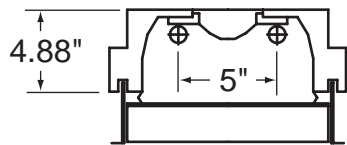
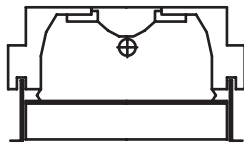
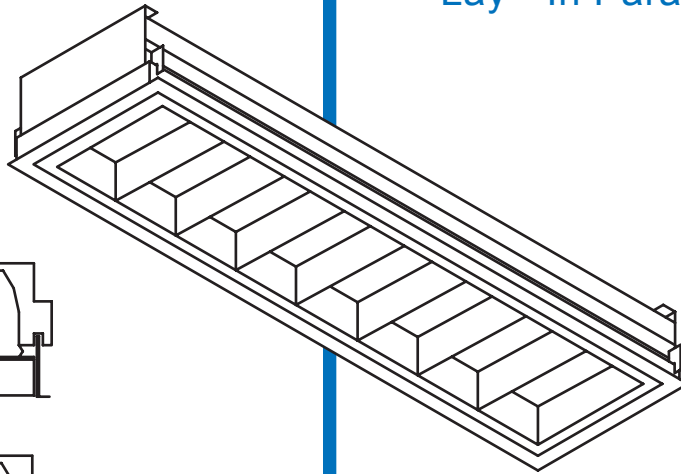

UNION MADE IN THE USA.

ORDERING:

NOMINAL SIZE	LAMPS	CATALOG NUMBER
1' X 4'	1-F032	379-PL8-148T8
1' X 4'	2-F032	379-PL8-248T8
1' X 4'	3-F032	379-PL8-348T8

INSERT VOLTAGE AT END OF CATALOG NUMBER



FEATURES:

- 1, 2 OR 3 LAMP CONFIGURATION
- AVAILABLE WITH 8 OR 16 CELL 3" LOUVERS
- OPTIONAL POST PAINTED HIGH REFLECTANCE WHITE POWDER COAT FINISH ON REFLECTIVE SURFACES
- OPTIONAL DIFFUSER OVERLAY

NOTES:

1. TO ORDER A 16 CELL LOUVER REPLACE PL8 WITH PL16 IN CATALOG NUMBER
2. NOT DESIGNED FOR WET OR HARSH ENVIRONMENTS

BACK DETAIL

	WIRE ACCESS COVER PLATE
	7/8" K.O.
Back detail symbols	

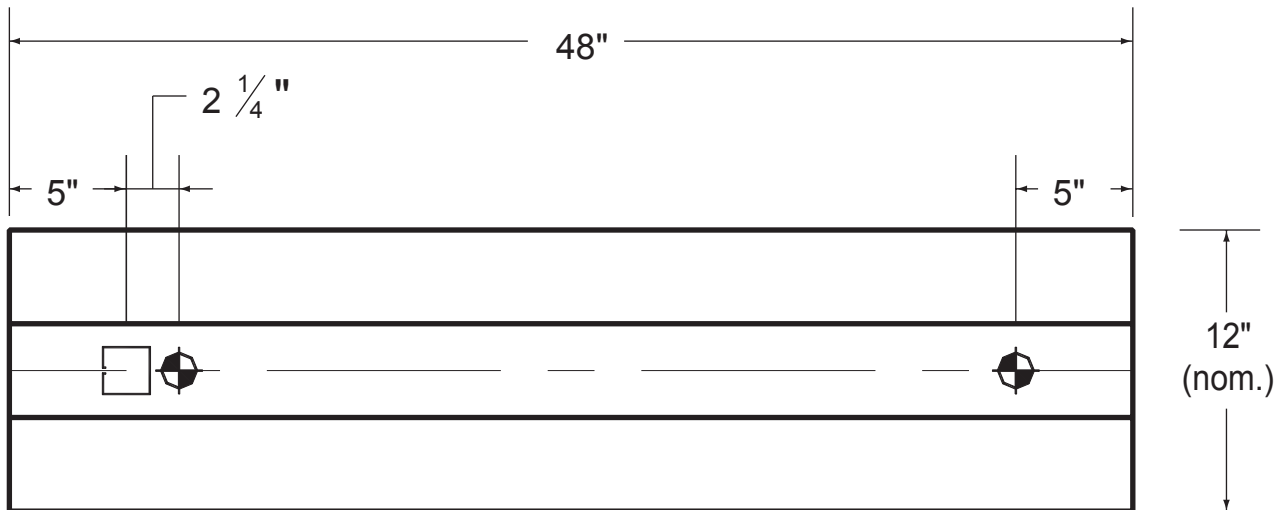

NOTE
All fixtures must be installed,
wired and grounded in accordance
with the National Electric Code and all
other applicable codes.

!!! WARNING !!!
RISK OF FIRE OR ELECTRICAL SHOCK. ELECTRICAL
PARTS MAY BE DAMAGED WHEN DRILLING OR USING
"TEK" SCREWS FOR INSTALLATION OF MOUNTING
HARDWARE. CHECK ENCLOSED WIRING AND
COMPONENTS. USE CAUTION WHEN DRILLING "TEK"
SCREWS INTO A BLIND AREA. TO PREVENT WIRING
DAMAGE DO NOT EXPOSE WIRING TO SHARP EDGES.

